

CONNECTORS TERMINAL LUGS

Each lug has stamped-in designation of thermocouple type and polarity
e.g. JP = Type J positive
JN = Type J negative
(Exception "CU" uncompensated is not designated)

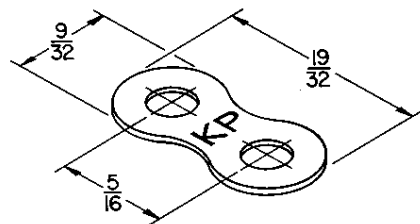
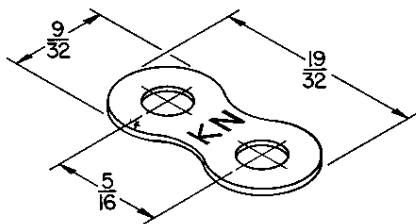

PART NO.	PRICE-SET	HOLE SPACING	FITS CINCH NO.
2140 - (*)		5/16	140

(*) Specify type J,K,T,E,R,S,CU,N

Each lug has stamped-in designation of thermocouple type and polarity
e.g. JP = Type J positive
JN = Type J negative
(Exception "CU" uncompensated is not designated)

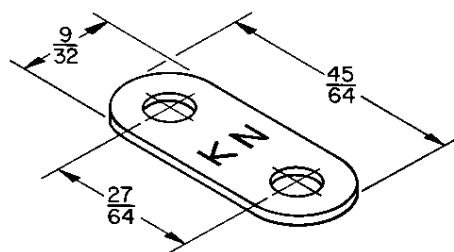
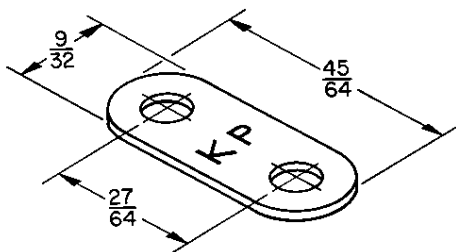

PART NO.	PRICE-SET	HOLE SPACING	FITS CINCH NO.
2141 - (*)		27/64	141

(*) Specify type J,K,T,E,R,S,CU,N

TERMINAL LUGS WITH BARRIER STRIP

- 20 Terminals/10 Thermocouple Circuits max per strip
- Molded of bakelite
- Strips are shipped fully assembled with terminal lugs mounted
- 5-40 B.H.D. Screws
- Cinch No. 140
- Hole Spacing 5/16"

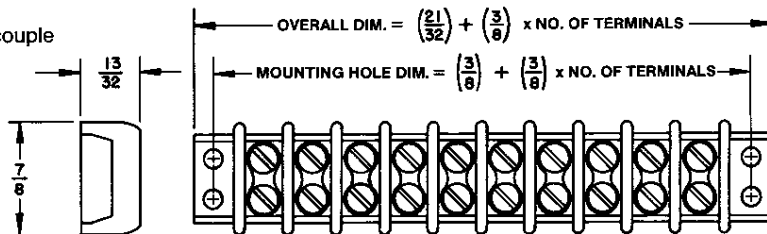

PART NO.	PRICE-CIRCUIT
BS-2140-(*)-()	

(*) Specify type J,K,T,E,R,S,CU,N
() Specify number of thermocouple circuits

- 20 Terminals/10 Thermocouple Circuits max per strip
- Molded of bakelite
- Strips are shipped fully assembled with terminal lugs mounted
- 6-32 B.H.D. Screws
- Cinch No. 141
- Hole Spacing 27/64"

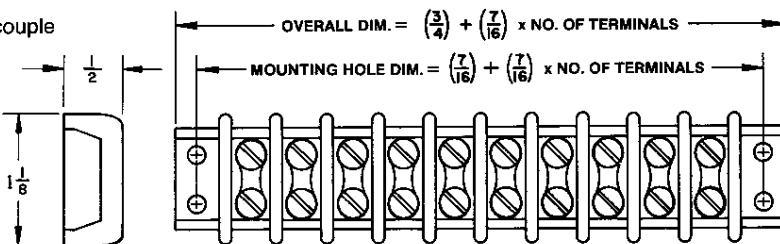

PART NO.	PRICE-CIRCUIT
BS-2141-(*)-()	

(*) Specify type J,K,T,E,R,S,CU,N
() Specify number of thermocouple circuits

TERMINAL SPADE LUGS

Each spade lug has stamped-in designation of thermocouple alloy type.

- e.g. CH = CHROMEL
AL = ALUMEL
IR = IRON
CO = CONSTANTAN
CP = COPPER
II = ALLOY II
NP = NICROSIL
NN = NISIL

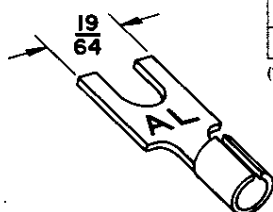

PART NO.	PRICE - EACH
SL-2141-(*)	

(*) Specify thermocouple alloy

Fits 6-32 (CINCH-141) Terminal Screws. Accepts up to 18 ga. wire for crimp connection.